



GH-180T

GH-180T Hydraulic grip

- Clamping force 180kN/315bar
- 3 rods 50 mm diameter with spring return
Max movement of rod : 15mm
- Standard temperature range: 0 °C - +70°C
- Hydraulic connection: 1/4"
- Body: Steel surface, black or Nickel coated
- Weight: ~55kg each (without jaws)
- Scope of supply: 1 pair



Jaw faces for GH-180T: Scope of delivery: 1 set = 4 jaw faces



- Blank (smooth) jaws**
- Steel blanks without coating
 - Suitable for further treatments



- Pyramid (serrated, cross cut) jaws**
- Hardened steel 58 HRC
 - Manganese phosphate coating
 - Pyramids 1.2x45°



- V-Jaws**
- All kinds of round samples
 - Hardened steel 58 HRC
 - Manganese phosphate coating
 - Tooth pitch 1.2 mm



- Wave jaws (corrugated)**
- Wave 5 mm
 - Hardened steel 58 HRC
 - Manganese phosphate coating

Item number	Clamping surface	Clamping surface H x B	Opening	Weight/ 1 pair
GH-180T-B	Blank jaw faces	70 x 210mm	0 – 30 mm	~ 6.7kg
GH-180T-BP	Pyramid jaw faces	70 x 120mm	0 – 30 mm	~ 6.7kg
GH-180T-BV	V-jaws	Clamping height 70mm	8 – 30 mm Ø	~ 6.7kg
GH-180T-BW	Wave jaw faces	70 x 210mm	0 – 20 mm	~ 6.7kg

Additional jaws (dimensions and surface coatings) available on request.

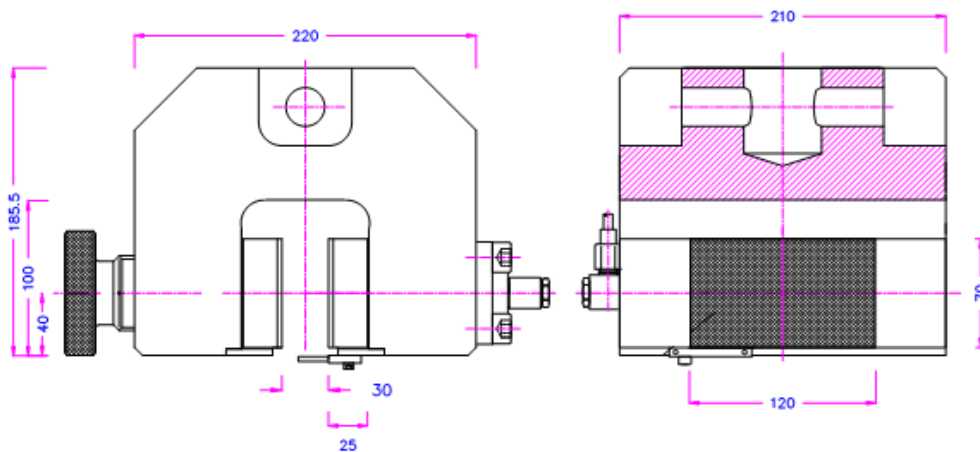

GH-180T with GH-180T-BP

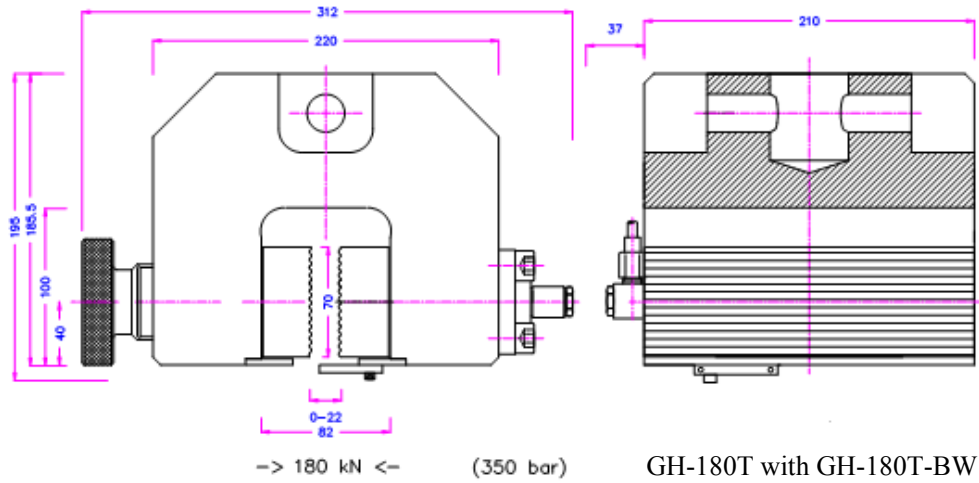

Accessories:



GH135-P2

Air hydraulic pump
 Max pressure: 350 bar, pressure ratio air:hydraulic 1:61
 2 valves for separate switching of the grips (opening, closing)
 Remote control with 2 switches: ~220V ; 0.1 A
 Dimensions LxWxH: 315mm x 250mm x 500mm); weight ~25 kg



GH135-P2-G-a

Air hydraulic pump similar to TH135-P2 including:
 - Housing for noise reduction
 - Analogue pressure transducer: analogue signal 1 -10 V to adjust the clamping pressure from 40 to 400 bar
 Dimensions LxWxH: 720mm x 360mm x 630mm; weight: ~38 kg



GH135-P2-2-G-a

Air hydraulic pump similar to TH135-P2 including:
 - 4 valves to lock the jaws at any required position
 - Housing for noise reduction
 - Analogue pressure transducer: analogue signal 1 -10 V to adjust the clamping pressure from 40 to 400 bar
 Dimensions LxWxH: 720mm x 360mm x 630mm; weight: ~50 kg