

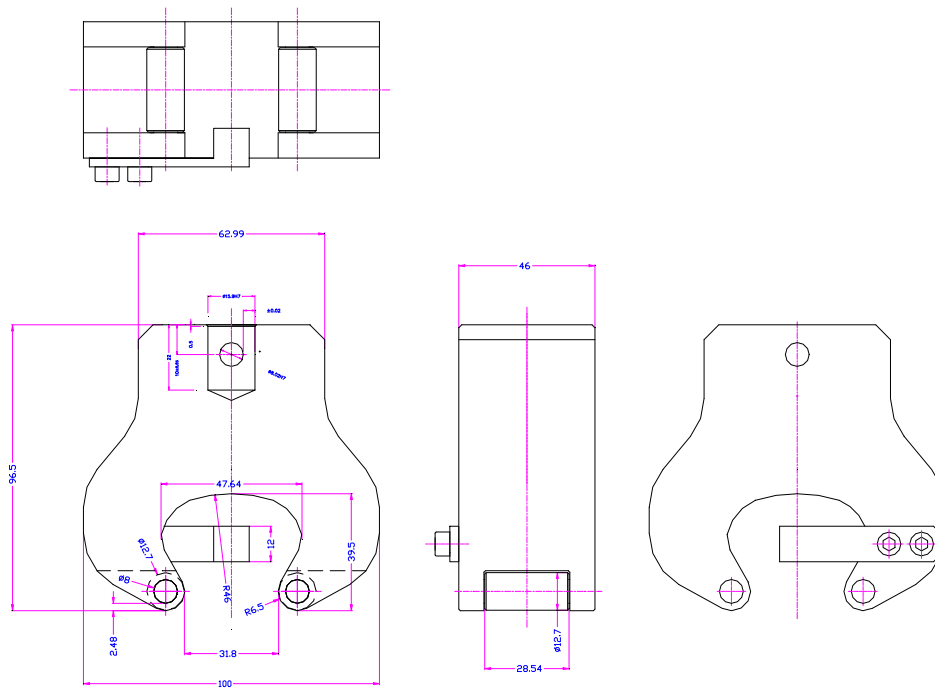

ASTM C307 Fixture

ASTM C307 Tensile Fixture for Testing Chemical-Resistant Mortar, Grouts and Monolithic

- Conforms to ASTM C307
- Sample accommodation limits:
 - 76.2mm long
 - 44.5mm wide
 - 25.4mm thick
- Standard temperature range: 0 °C - +70°C
- Body: Steel surface, Nickel coated
- Weight: ~5kg



Chuck Grips per ASTM C307